



ECLISSE SYNTESIS® LINE BATTENTE

ECLISSE SYNTESIS® LINE BATTENTE

is the ECLISSE solution that allows installing a hinged door flushing with the wall, this means a door with no frame: no jambs, no architraves.

The doors can be painted in the same colour of the wall, perfectly hiding from the view, and blending in with the rest of the wall.

Alternatively, the door panel can be



lacquered or decorated with finishing or prints that emphasize them, becoming real design elements.

The same aesthetic and structural characteristics are present in the frameless sliding pocket door systems ECLISSE SYNTESIS® LINE and ECLISSE SYNTESIS® LUCE.

Matching both solutions together, sliding and hinged, you can get a perfectly coherent and minimal result.





ALUMINIUM FRAME



1. Long lasting and paintable.

The aluminium frame is firstly subjected to anodization treatment against oxidation and then it is primer-coated to facilitate paint cohesion.

2. Very strong frame.

The frame profile weighs about 2 kg/m.

3. NO cracks!

The frame profile is specially designed to avoid cracks.

4. Spacer panels in OSB 3.

25 mm thick and pre-assembled to guarantee a perfect squaring of the frame.

5. 6 adjustable clamps.

The clamps are adjustable for height and prepared to be easily fixed to solid wall.

6. Trademark.

The frame is recognisable thanks to the trademark.

7. Quote 100 mm.

It helps the installer finding the "0" quote.

THE ADVANTAGES:

- UNIQUE frame, for both stud and solid wall.
- Supplied with a plastic protection to avoid dirty and scratches in construction site.
- Door seal applicable on the frame, not on the door. Stable, easy to install, soft and aesthetically pleasant.
- Cover for door hinge to protect hinges from plaster (pull version).



ECLISSE SYNTESIS® LINE BATTENTE DOOR



THE DOOR.

Primer-coated to improve cohesion of wall paint and lacquer (both opaque and glossy)
 - Full hollow core with double solid wood perimeter to improve inflexibility.



THE MAGNETIC LOCK

Magnetic lock.

It has modern design and minimal lines; it remains "flush" and guarantees an extraordinary softness while closing.

Eccentric strike plate.

- Minimal design, it remains "flush"
- Eccentric: it allows fixing little installation imperfections, guaranteeing a perfect locking.

Note: it comes standard without lock or lock with key.
 Turn knob lock on request.

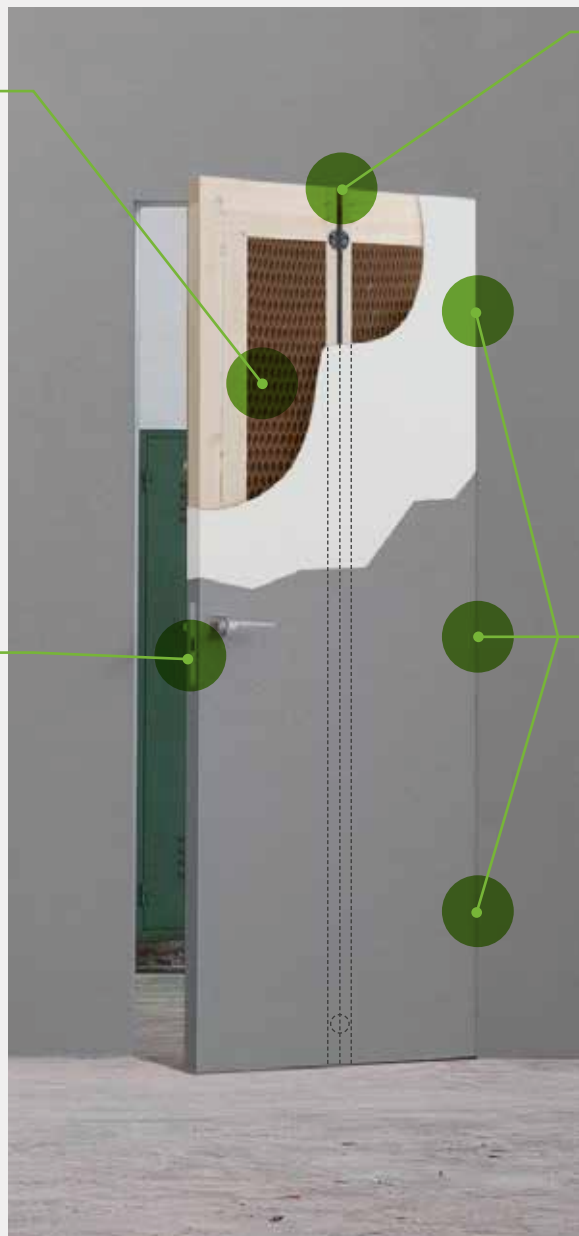

TENSIONING ROD*

Special adjustable device. It helps the door panel keeping constant tension, improving the door flatness.

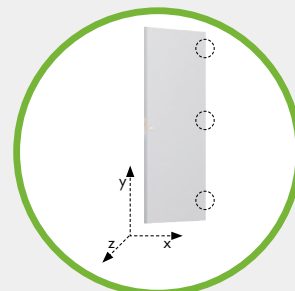

THE HINGES

3 Triple adjustable hinges (height, width, depth) for a perfect calibration of the perimeter size.

Note: when the door weighs more than 50 kg (max 65 kg), 4 hinges are needed.

THE DOOR:

- Is recognisable thanks to the ECLISSE trademark.
- Has an universal outline adaptable to opening side (right or left).

- Is 45 mm thickness
- Is finished with a border all along the perimeter.

* It comes standard with door panels with H starting from 2000 mm.

ECLISSE SYNTESIS® LINE BATTENTE OPENING



TYPE: CHOOSE THE OPENING - BATTENTE



ECLISSE SYNTESIS® LINE BATTENTE

PUSH DOOR

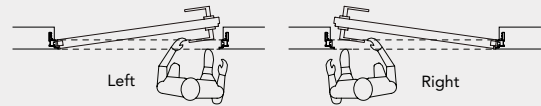

PULL DOOR

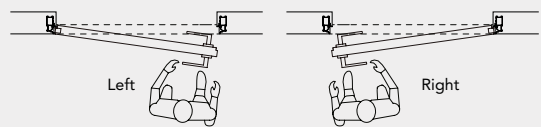

VERSION: WITH OR WITHOUT HEADER

The distinctive feature of ECLISSE SYNTESIS® LINE BATTENTE is the possibility to install the doors flush with the ceiling with or without a header in order to achieve a total integration among door, wall and ceiling.

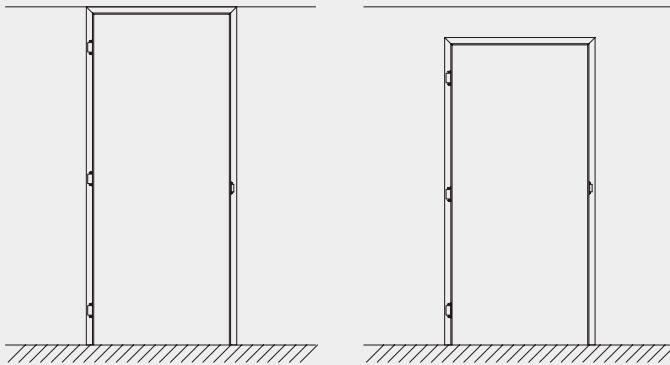

With header

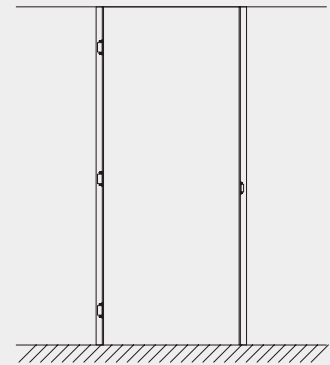

Without header

ECLISSE SYNTESIS® LINE BATTENTE OPENING



TYPE: CHOOSE THE OPENING - BATTENTE DOUBLE



ECLISSE SYNTESIS® LINE BATTENTE DOUBLE

PUSH DOOR LEFT - RIGHT DOOR FIXED

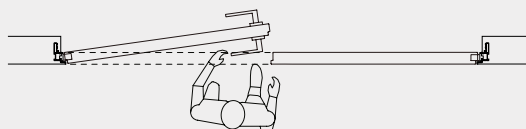

PULL DOOR LEFT - RIGHT DOOR FIXED

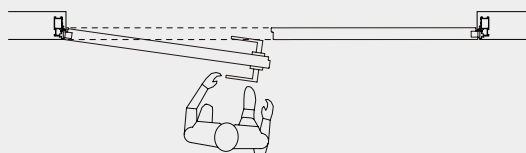

ECLISSE SYNTESIS® LINE BATTENTE DOUBLE

PUSH DOOR RIGHT - LEFT DOOR FIXED

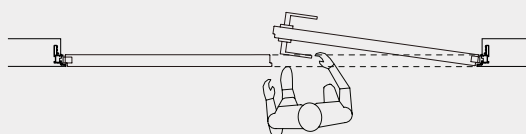

PULL DOOR RIGHT - LEFT DOOR FIXED

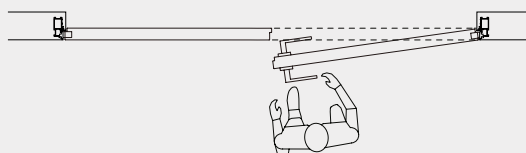

VERSION: WITH OR WITHOUT HEADER

ECLISSE SYNTESIS® LINE BATTENTE DOUBLE with header only.

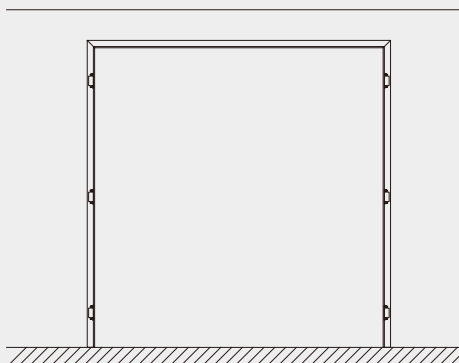
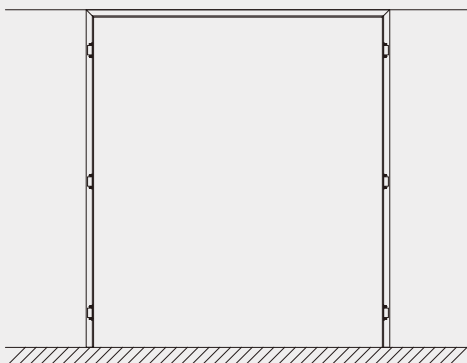

With header

- on ECLISSE SYNTESIS® LINE BATTENTE DOUBLE the fixed door closes with latch (supplied as standard).

ECLISSE SYNTESIS® LINE BATTENTE OPENING



SUPPLY METHODS

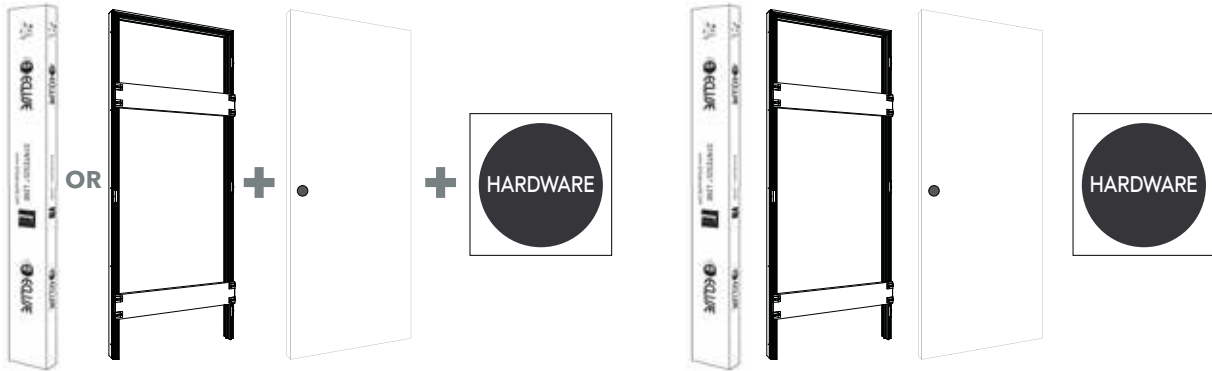

THE COMPLETE KIT

The complete KIT supply includes frame structure (in kit or assembled), door and hardware.
(Only for ECLISSE SYNTESIS® LINE BATTENTE SINGLE)

SINGLE ELEMENTS

ACCESSORIES

HARDWARE



Hardware includes a door seal, a lock, a strike plate, 3 hinges, 3 covers for door hinge and a screw bag.

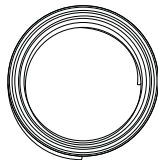

Door seal, length 6,6 m, to be cut to reqd. length.

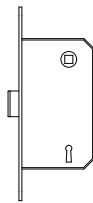

Lock

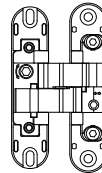

Hinges



Cover for door hinge



Eccentric strike plate

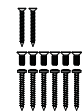

Screw bag

DOOR-CLOSER

Invisible from the outside, the door-closer is available in four variants: with stopping, without stopping, right, left.
The application of door-closer requires a special processing on the frame and the door panel that has to be specified when ordering.

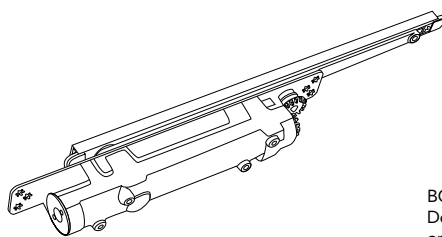

Door-closer

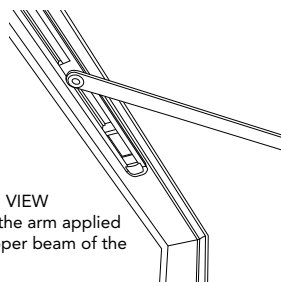

BOTTOM VIEW
Detail of the arm applied on the upper beam of the frame.

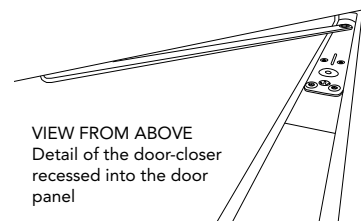

VIEW FROM ABOVE
Detail of the door-closer recessed into the door panel

ECLISSE SYNTESIS® LINE BATTENTE OPENING

info
TECHNICAL
DATA

PUSH DOOR

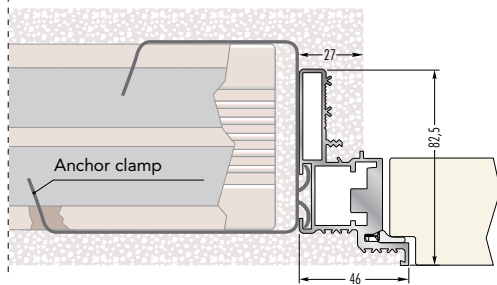

Frame on solid wall

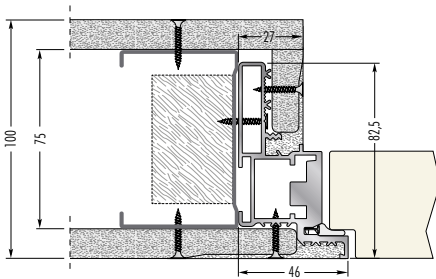

Frame on solid wall with one plasterboard
Finished wall thickness 100 mm

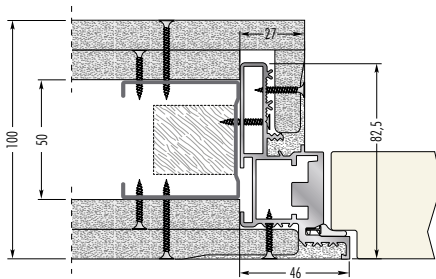

Frame on stud wall with two plasterboards
Finished wall thickness 100 mm

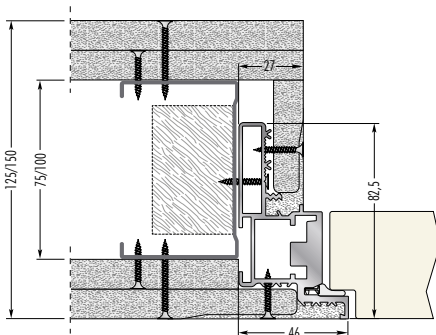

Frame on stud wall with two plasterboards
Finished wall thickness 125/150 mm

PULL DOOR

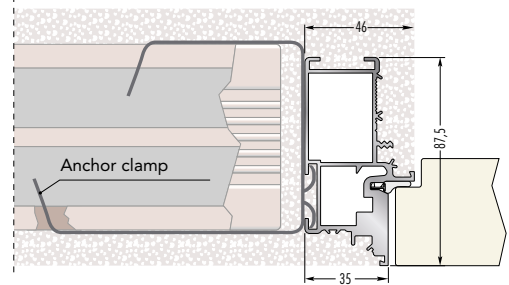

Frame on solid wall

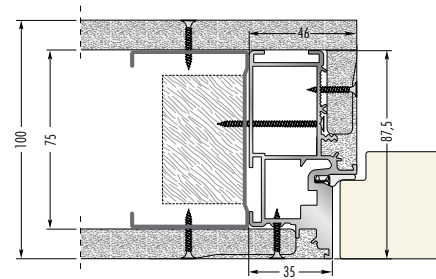

Frame on solid wall with one plasterboard
Finished wall thickness 100 mm

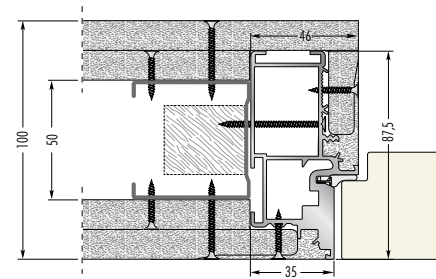

Frame on stud wall with two plasterboards
Finished wall thickness 100 mm

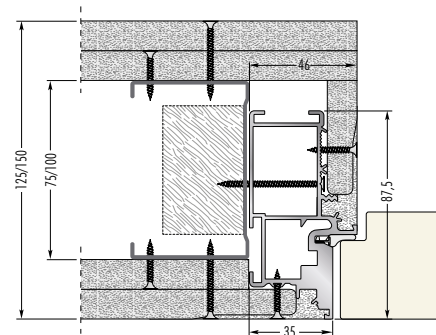

Frame on stud wall with two plasterboards
Finished wall thickness 125/150 mm

The frame fits both with stud and solid wall. For solid wall 6 clamps are cemented in the special spaces created in the wall. For stud wall the frame is fixed with screws to the metal structure through the existing holes.

ECLISSE SYNTESIS® LINE BATTENTE SIZES

info
TECHNICAL
DATA

FRAME WITH HEADER

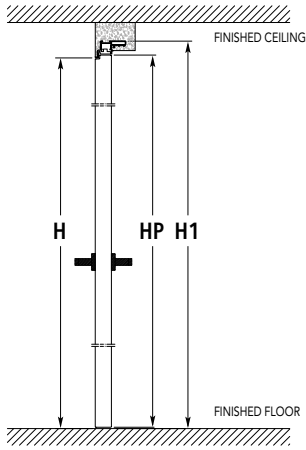

FRAME WITHOUT HEADER

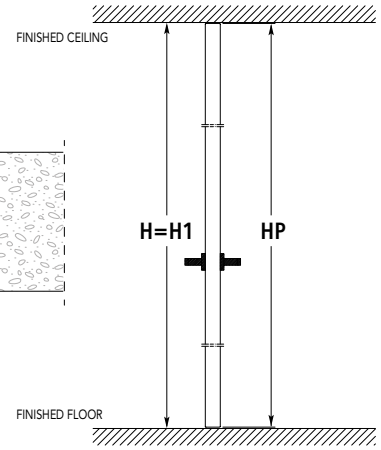

PUSH DOOR

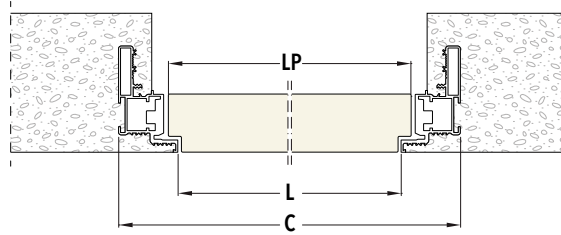

FRAME WITH HEADER

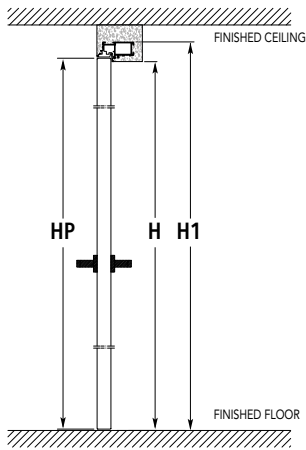

FRAME WITHOUT HEADER

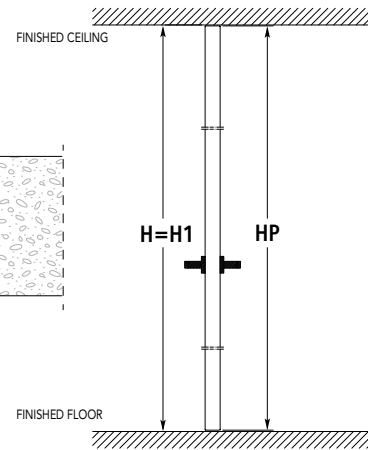

PULL DOOR

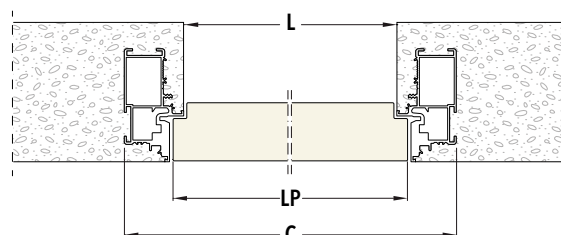

FRAME WITH HEADER						FRAME WITHOUT HEADER					
PASSAGE SIZE		OVERALL DIMENSIONS		DOOR PANEL 45 mm thick		PASSAGE SIZE		OVERALL DIMENSIONS		DOOR PANEL 45 mm thick	
L	H	C	H1	LP	HP	L	H	C	H1	LP	HP
600	2100/2400	692	2146/2446	616	2104/2404	600	2700	692	2700	616	2693
650	2100/2400	742	2146/2446	666	2104/2404	650	2700	742	2700	666	2693
700	2100/2400	792	2146/2446	716	2104/2404	700	2700	792	2700	716	2693
750	2100/2400	842	2146/2446	766	2104/2404	750	2700	842	2700	766	2693
800	2100/2400	892	2146/2446	816	2104/2404	800	2700	892	2700	816	2693
850	2100/2400	942	2146/2446	866	2104/2404	850	2700	942	2700	866	2693
900	2100/2400	992	2146/2446	916	2104/2404	900	2700	992	2700	916	2693
950	2100/2400	1042	2146/2446	966	2104/2404	950	2700	1042	2700	966	2693
1000	2100/2400	1092	2146/2446	1016	2104/2404	1000	2700	1092	2700	1016	2693

SIZES ARE GIVEN IN mm

- Intervals for height every 50 mm, from 1650 mm to 2700 mm.
- Variations in H can be realized in centimeters in the version without header.

- Version with header: height overall dimension is always higher than 46 mm compared to height size H.

- Version with header: it's possible to have a variation with height overall dimension 2700 mm and passage size 2654 mm.

ECLISSE SYNTESIS® LINE BATTENTE APPLICATIONS

info
TECHNICAL
DATA

FRAME WITH HEADER - PUSH

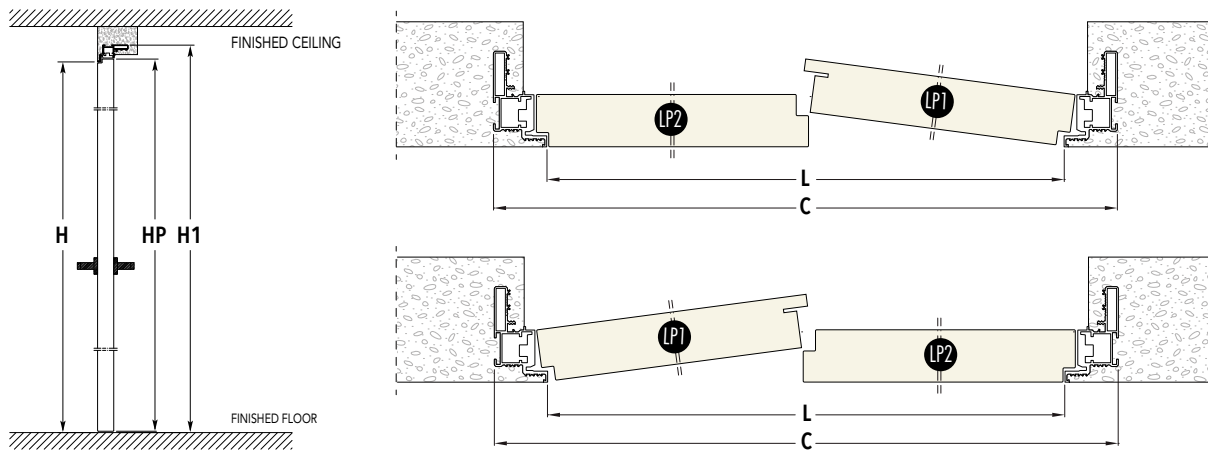

FRAME WITH HEADER - PULL

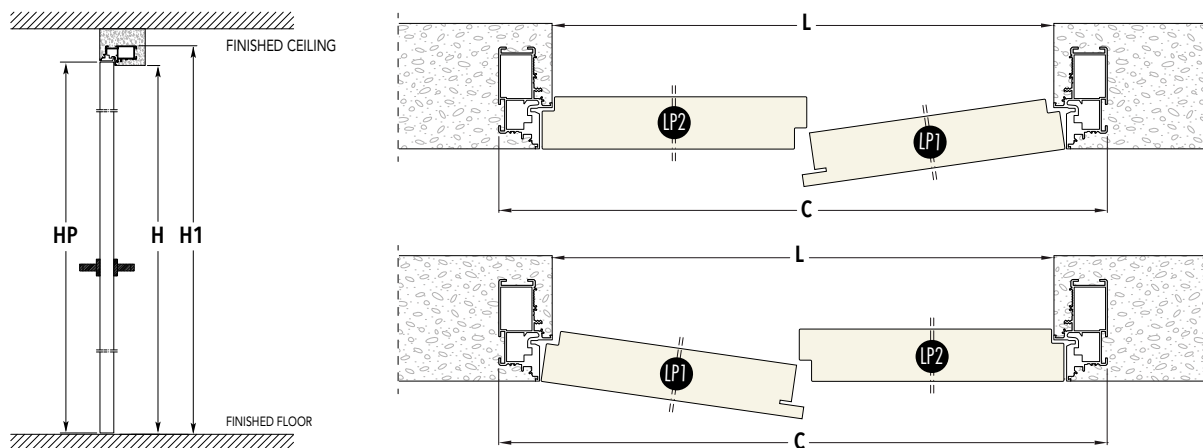

FRAME WITH HEADER

PASSAGE SIZE		OVERALL DIMENSIONS		DOOR PANEL 45 mm thick		
L	H	C	H1	LP1	LP2	HP
1200	2100/2400	1292	2146/2446	606	616	2104/2404
1300	2100/2400	1392	2146/2446	656	666	2104/2404
1400	2100/2400	1492	2146/2446	706	716	2104/2404
1500	2100/2400	1592	2146/2446	756	766	2104/2404
1600	2100/2400	1692	2146/2446	806	816	2104/2404
1700	2100/2400	1792	2146/2446	856	866	2104/2404
1800	2100/2400	1892	2146/2446	906	916	2104/2404
1900	2100/2400	1992	2146/2446	956	966	2104/2404
2000	2100/2400	2092	2146/2446	1006	1016	2104/2404

SIZES ARE GIVEN IN mm

- Intervals for height every 50 mm, from 1650 mm to 2700 mm.

- Height overall dimension is always higher than 46 mm compared to height size H.

- It's possible to have a variation with height overall dimension 2700 mm and passage size 2654 mm.



Via Sernaglia, 76 | 31053 Pieve di Soligo TV | T. +39 0438 985749 | F. +39 0438 837245 | international.sales@eclisse.it | www.eclisseworld.com

Follow us on:

